

Pipe Systems

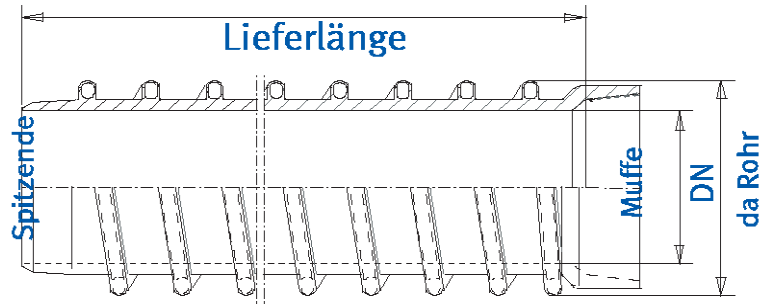

Pipe according to DIN 16961



Delivery Length: 6,0m
 Specific Length: according to inquiry
 Inside Surface: coextruded, colored Inliner
 Socket: Form I, Extrusion welding
 Socket: Form I, E-socket welding
 Socket: Form III, flat ends
 Material: PE- HD

| Profile execution Nr. 1 | Outside diameter DA in the stiffness grades | | | |
|-------------------------|---|------|------|-------|
| DN | SN 2 | SN 4 | SN 8 | SN 16 |
| 350 | - | - | - | 420 |
| 400 | - | - | 470 | 470 |
| 450 | - | - | 520 | 520 |
| 500 | - | 570 | 570 | 570 |

Profile- Spiral Pipe Type II

Pipe according to DIN 16961

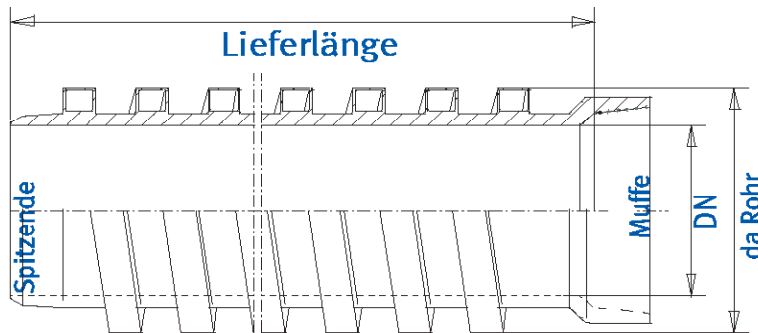

Delivery Length:
Specific Length:
Inside Surface:
Socket:
Socket:
Socket:
Material:

6,0m
according to inquiry
coextruded, colored Inliner
Form I, Extrusion welding
Form I, E- Socket welding
Form III, flat ends
PE- HD

| Profile execution Nr. 2 | Outside diameter DA in the stiffness grades | | | |
|-------------------------|---|------|------|-------|
| DN | SN 2 | SN 4 | SN 8 | SN 16 |
| 350 | - | - | 410 | 425 |
| 400 | - | 460 | 175 | 480 |
| 450 | - | 510 | 525 | 530 |
| 500 | 560 | 575 | 580 | 590 |
| 550 | 610 | 625 | 630 | 655 |
| 600 | 675 | 675 | 685 | 715 |
| 700 | 775 | 780 | 800 | 825 |
| 800 | 880 | 895 | 915 | 940 |
| 900 | 995 | 995 | 1010 | - |
| 1000 | 1095 | 1110 | 1140 | - |
| 1200 | 1310 | 1335 | 1365 | - |
| 1300 | 1435 | 1435 | 1440 | - |
| 1400 | 1535 | 1550 | - | - |
| 1500 | 1635 | 1660 | - | - |
| 1600 | 1735 | - | - | - |
| 1800 | 1970 | - | - | - |
| 2000 | 2175 | - | - | - |

HENZE GmbH
Kunststoffwerk

Josef-Kitz-Str. 9
53840 Troisdorf

tel: +49 (0) 2241- 98 19 0
fax: +49 (0) 2241- 98 19 20

e-mail: info@henze-gmbh.de
internet: www.henze-gmbh.de

Pipe according to DIN 16961

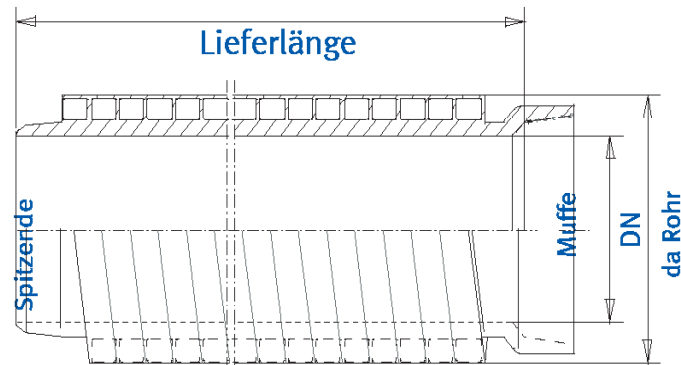

Delivery Length: 6,0m
Specific Length: according to inquiry
Inside Surface: coextruded, colored Inliner
Socket: Form I, Extrusion welding
Socket: Form I, E-socket welding
Socket: Form III, flat ends
Material: PE- HD

Profile execution Nr. 3 Outside diameter DA in the nominal stiffness grades

| DN | SN 2 | SN 4 | SN 8 | SN 16 |
|--------------------|------|------|------|-------|
| 350 | - | - | - | 425 |
| 400 | - | - | - | 475 |
| 450 | - | - | - | 525 |
| 500 | - | - | 575 | 580 |
| 550 | - | - | 625 | 640 |
| 600 | - | - | 675 | 695 |
| 700 | - | 775 | 795 | 810 |
| 800 | 875 | 880 | 900 | 925 |
| 900 | 975 | 995 | 1010 | - |
| 1000 | 1080 | 1100 | 1120 | - |
| 1200 | 1295 | 1315 | 1350 | - |
| 1300 | 1410 | 1435 | 1460 | - |
| 1400 | 1510 | 1535 | - | - |
| 1500 | 1615 | 1645 | - | - |
| 1600 | 1735 | 1755 | - | - |
| 1800 | 1940 | 1980 | - | - |
| 2000 | 2165 | 1755 | - | - |
| 2200 ¹⁾ | 2415 | 2460 | - | - |
| 2300 ²⁾ | 2480 | 2525 | - | - |
| 2400 | 2600 | - | - | - |
| 2600 ³⁾ | 2805 | - | - | - |
| 3000 | 3255 | - | - | - |
| 3600 ³⁾ | - | - | - | - |

¹⁾ Length of pipe L= 4300
³⁾ Length of pipe L= 3750

²⁾ In preparation

Profile-Spiral Pipe Type IV

Pipe according to DIN 16961

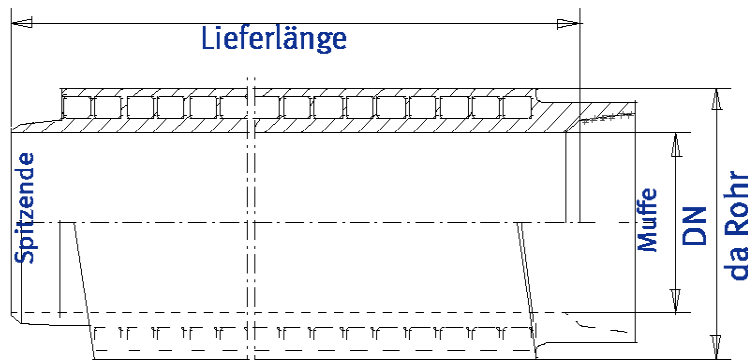

Delivery Length: 6,0m
 Specific Length: according to inquiry
 Inside Surface: coextruded, colored Inliner
 Socket: Form I, Extrusion welding
 Socket: Form I, E- Socket welding
 Socket: Form III, flat ends
 Material: PE- HD

| Profile execution Nr. 4 | Outside diameter DA in the nominal stiffness grades | | | |
|-------------------------|---|------|------|-------|
| DN | SN 2 | SN 4 | SN 8 | SN 16 |
| 350 | - | - | - | 435 |
| 400 | - | - | - | 435 |
| 450 | - | - | - | 535 |
| 500 | - | - | - | 635 |
| 550 | - | - | - | 690 |
| 600 | - | - | 685 | 800 |
| 700 | - | - | 785 | 915 |
| 800 | - | 885 | 890 | 1030 |
| 900 | - | 985 | 1005 | 1140 |
| 1000 | 1085 | 1090 | 1120 | 1370 |
| 1200 | 1285 | 1310 | 1345 | 1485 |
| 1300 | 1390 | 1420 | 1450 | 1595 |
| 1400 | 1505 | 1525 | 1560 | 1710 |
| 1500 | 1610 | 1650 | 1670 | 1820 |
| 1600 | 1720 | 1750 | 1780 | 2050 |
| 1800 | 1930 | 1980 | 2005 | 2280 |
| 2000 | 2150 | 2185 | 2230 | - |
| 2200 ¹⁾ | 2420 | 2450 | 2495 | - |
| 2300 ²⁾ | 2480 | 2515 | 2560 | - |
| 2400 | 2585 | 2620 | 2665 | - |
| 2600 ³⁾ | 2815 | 2870 | 2900 | - |
| 3000 | 3220 | 3280 | 3335 | - |
| 3600 ³⁾ | 3870 | 3920 | - | - |

¹⁾ Length of pipe L= 4300
³⁾ Length of pipe L= 3750

²⁾ In preparation

HENZE GmbH
Kunststoffwerk

Josef-Kitz-Str. 9
53840 Troisdorf

tel: +49 (0) 2241- 98 19 0
fax: +49 (0) 2241- 98 19 20

e-mail: info@henze-gmbh.de
internet: www.henze-gmbh.de

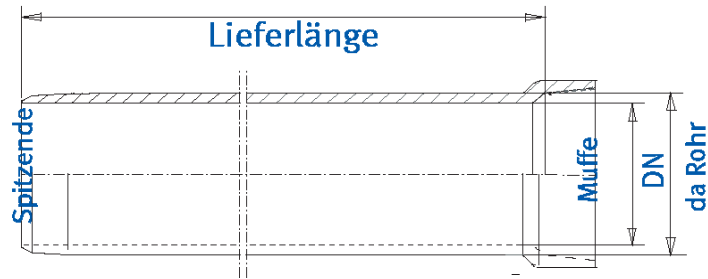

Delivery Length: 6,0m
Specific Length: according to inquiry
Inner Surface: coextruded, colored Inliner
Socket: Form I, Extrusion welding
Socket: Form I, E- Socket welding
Socket: Form III, Flat ends
Material: PE- HD

Weights per meter
 Nominal width and wall thickness in mm

| DN | 5 | 6 | 7 | 8 | 9 | 10 | 11 | 12 | 13 | 14 | 15 | 16 | PIPE LENGTH L |
|------|------|------|------|------|------|------|------|------|------|------|------|------|---------------|
| 350 | 5,6 | 6,7 | 7,9 | 9,0 | 10,2 | 11,3 | 12,5 | 13,6 | 14,8 | 16,0 | 17,2 | 17,2 | 6000 |
| 400 | 6,4 | 7,7 | 9,0 | 10,3 | 11,6 | 12,9 | 14,2 | 15,5 | 16,9 | 18,2 | 19,6 | 19,6 | 6000 |
| 450 | 7,1 | 8,6 | 10,0 | 11,5 | 13,0 | 14,4 | 15,9 | 17,4 | 18,9 | 20,4 | 21,9 | 21,9 | 6000 |
| 500 | 7,9 | 9,5 | 11,1 | 12,8 | 14,4 | 16,0 | 17,7 | 19,3 | 20,9 | 22,6 | 24,3 | 24,3 | 6000 |
| 550 | 8,7 | 10,5 | 12,2 | 14,0 | 15,8 | 17,6 | 19,4 | 21,2 | 23,0 | 24,8 | 26,6 | 26,6 | 6000 |
| 600 | 9,5 | 11,4 | 13,3 | 15,3 | 17,2 | 19,2 | 21,1 | 23,1 | 25,0 | 27,0 | 29,0 | 29,0 | 6000 |
| 650 | 10,3 | 12,4 | 14,4 | 16,5 | 18,6 | 20,7 | 22,8 | 24,9 | 27,1 | 29,2 | 31,3 | 31,3 | 6000 |
| 710 | 11,1 | 13,3 | 15,5 | 17,8 | 20,0 | 22,3 | 24,6 | 26,8 | 29,1 | 31,4 | 33,7 | 33,7 | 6000 |
| 800 | 12,6 | 15,2 | 17,7 | 20,3 | 22,9 | 25,4 | 28,0 | 30,6 | 33,2 | 35,8 | 38,4 | 38,4 | 4000 |
| 900 | 14,2 | 17,1 | 19,9 | 22,8 | 25,7 | 28,6 | 31,5 | 34,4 | 37,3 | 40,2 | 43,1 | 43,1 | 6000 |
| 1000 | 15,8 | 19,0 | 22,1 | 25,3 | 28,5 | 31,7 | 34,9 | 38,1 | 41,4 | 44,6 | 47,8 | 47,9 | 6000 |
| 1200 | 18,9 | 22,7 | 26,5 | 30,2 | 34,2 | 38,0 | 41,8 | 45,7 | 49,5 | 53,3 | 57,2 | 61,1 | 6000 |
| 1300 | 20,5 | 24,6 | 28,7 | 32,8 | 36,9 | 41,0 | 45,1 | 49,2 | 53,3 | 57,7 | 61,9 | 65,6 | 6000 |
| 1400 | 22,1 | 26,5 | 30,9 | 35,4 | 39,8 | 44,3 | 48,7 | 53,2 | 57,7 | 62,2 | 66,7 | 71,1 | 6000 |
| 1500 | 23,6 | 28,4 | 33,1 | 37,9 | 42,6 | 47,4 | 52,2 | 57,0 | 61,8 | 66,6 | 71,4 | 76,2 | 6000 |
| 1600 | 25,2 | 30,3 | 35,3 | 40,4 | 45,5 | 50,6 | 55,6 | 60,7 | 65,8 | 71,0 | 76,1 | 81,2 | 6000 |
| 1800 | 28,3 | 34,0 | 39,7 | 45,4 | 51,1 | 56,8 | 62,5 | 68,2 | 74,0 | 79,7 | 85,4 | 91,2 | 6000 |
| 1900 | 29,9 | 35,9 | 41,9 | 47,9 | 54,0 | 60,0 | 66,0 | 72,0 | 78,1 | 84,1 | 90,2 | 96,3 | 4000 |
| 2000 | 31,0 | 38,0 | 44,0 | 50,0 | 57,0 | 63,0 | 69,0 | 76,0 | 82,0 | 89,0 | 95,0 | 101 | 6000 |
| 2240 | 35,2 | 42,3 | 49,3 | 56,4 | 63,5 | 70,6 | 77,7 | 84,8 | 92,0 | 99,0 | 106 | 113 | 4300 |
| 2400 | 37,8 | 45,3 | 52,9 | 60,5 | 68,1 | 75,7 | 83,3 | 90,9 | 98,5 | 106 | 113 | 121 | 4000 |
| 2600 | 40,9 | 49,1 | 57,3 | 65,5 | 73,7 | 82,0 | 90,2 | 98,4 | 107 | 115 | 12 | 131 | 4000 |
| 3000 | 47,2 | 56,6 | 66,1 | 75,6 | 85,0 | 94,5 | 104 | 113 | 123 | 132 | 142 | 151 | 6000 |
| 3600 | 56,6 | 67,9 | 73,3 | 90,7 | 102 | 113 | 125 | 136 | 148 | 159 | 170 | 182 | 4000 |

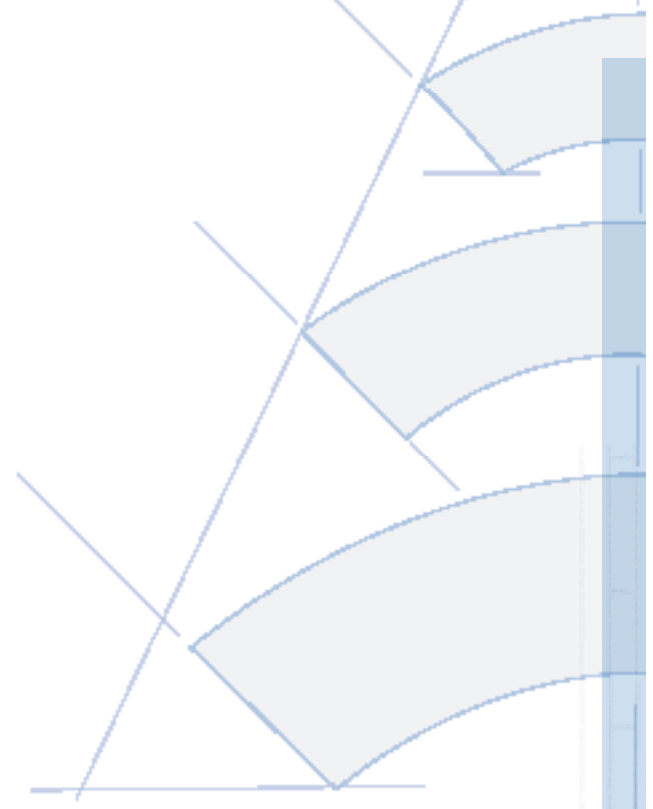

The manufacturing process of Henze GmbH makes it possible to produce any size of Wall thickness.

| DN | 17 | 18 | 19 | 20 | 21 | 22 | 23 | 24 | 25 | 30 | 35 | 40 | PIPE LENGTH L |
|------|------|------|------|------|------|------|------|------|------|-------|-------|-------|---------------|
| 350 | 19,6 | 20,9 | 22,0 | 23,2 | 24,5 | 26,0 | 27,0 | 28,2 | 29,4 | 35,8 | 42,3 | 49,0 | 6000 |
| 400 | 22,3 | 23,6 | 25,0 | 26,4 | 27,8 | 29,2 | 30,6 | 32,0 | 33,4 | 40,5 | 47,8 | 55,2 | 6000 |
| 450 | 24,9 | 26,5 | 28,0 | 29,5 | 31,1 | 32,6 | 34,2 | 35,7 | 3,3 | 45,2 | 53,3 | 61,5 | 6000 |
| 500 | 27,6 | 29,3 | 31,0 | 32,7 | 34,4 | 36,1 | 37,8 | 39,5 | 41,2 | 49,9 | 58,7 | 67,8 | 6000 |
| 550 | 30,3 | 32,1 | 34,0 | 35,8 | 37,7 | 39,5 | 41,4 | 43,3 | 45,1 | 54,6 | 64,2 | 74,1 | 6000 |
| 600 | 32,9 | 34,9 | 36,9 | 38,9 | 41,0 | 43,0 | 45,0 | 47,0 | 49,1 | 59,4 | 69,7 | 80,3 | 6000 |
| 650 | 35,6 | 37,8 | 39,9 | 42,1 | 44,3 | 46,4 | 48,6 | 50,8 | 43,0 | 64,1 | 75,2 | 86,6 | 6000 |
| 710 | 38,3 | 40,6 | 42,9 | 45,2 | 47,5 | 49,9 | 52,2 | 54,6 | 56,9 | 68,8 | 80,8 | 92,9 | 6000 |
| 800 | 43,6 | 46,2 | 48,9 | 51,5 | 54,1 | 56,5 | 59,4 | 62,1 | 64,8 | 78,2 | 91,7 | 105 | 4000 |
| 900 | 49,0 | 51,9 | 54,8 | 57,8 | 60,7 | 63,7 | 66,7 | 69,6 | 72,6 | 87,6 | 12 | 118 | 6000 |
| 1000 | 54,3 | 57,5 | 60,8 | 64,1 | 67,3 | 70,6 | 73,9 | 77,2 | 80,5 | 97,0 | 113 | 130 | 6000 |
| 1200 | 65,0 | 68,8 | 72,7 | 76,6 | 80,5 | 84,4 | 88,2 | 92,2 | 96,2 | 110 | 135 | 155 | 6000 |
| 1300 | 69,7 | 73,8 | 78,9 | 82,9 | 86,1 | 90,2 | 94,3 | 98,4 | 104 | 125,3 | 146,7 | 168,3 | 6000 |
| 1400 | 75,6 | 80,2 | 84,7 | 89,2 | 93,7 | 98,2 | 102 | 107 | 111 | 134 | 157 | 180 | 6000 |
| 1500 | 81,0 | 85,8 | 90,6 | 95,5 | 100 | 105 | 110 | 114 | 119 | 144 | 168 | 139 | 6000 |
| 1600 | 86,3 | 91,5 | 96,6 | 101 | 106 | 112 | 117 | 122 | 127 | 153 | 179 | 205 | 6000 |
| 1800 | 96,9 | 102 | 108 | 114 | 120 | 125 | 131 | 137 | 143 | 172 | 21 | 231 | 6000 |
| 1900 | 102 | 108 | 114 | 120 | 126 | 132 | 138 | 145 | 151 | 181 | 212 | 263 | 4000 |
| 2000 | 108 | 114 | 120 | 128 | 133 | 140 | 146 | 153 | 159 | 191 | 223 | 256 | 6000 |
| 2240 | 120 | 127 | 134 | 142 | 149 | 156 | 163 | 170 | 177 | 213 | 250 | 286 | 4300 |
| 2400 | 129 | 136 | 144 | 152 | 159 | 167 | 175 | 182 | 190 | 228 | 267 | 306 | 4000 |
| 2600 | 140 | 148 | 156 | 165 | 173 | 181 | 189 | 198 | 206 | 248 | 290 | 338 | 4000 |
| 3000 | 161 | 170 | 180 | 189 | 199 | 208 | 218 | 227 | 237 | 285 | 333 | 381 | 6000 |
| 3600 | 193 | 205 | 216 | 227 | 239 | 250 | 262 | 273 | 285 | 342 | 400 | 457 | 4000 |

HENZE GmbH
Kunststoffwerk

Josef-Kitz-Str. 9
53840 Troisdorf

tel: +49 (0) 2241- 98 19 0
fax: +49 (0) 2241- 98 19 20

e-mail: info@henze-gmbh.de
internet: www.henze-gmbh.de

Pipe according to DIN 16961

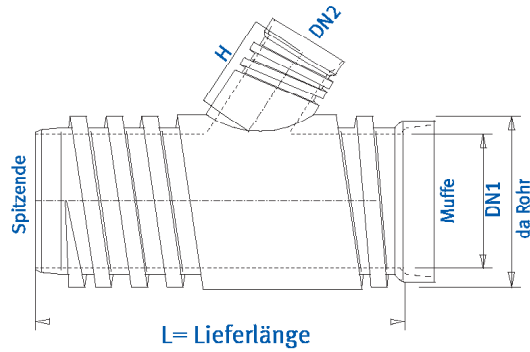

Delivery Length: 6,0m
Specific Length: according to inquiry
Inside Surface: coextruded, colored Inliner
Socket: Form I, Extrusion welding
Socket: Form I, E-socket welding
Socket: Form III, flat ends
Material: PE- HD

| Nominal Width Main Pipe | Nominal Widths branch 45°- 89°; T- Piece 90° | | | | | | | |
|----------------------------|--|-------------|-------------|-------------|-------------|-----------------------------|-----------------------|--------------------|
| DN 1 (mm) | DN2 (mm) | DN2 (mm) | DN2 (mm) | DN2 (mm) | DN2 (mm) | L (mm) | H (mm) 45°- 60° | H (mm) > 60° |
| 350 | 100 | 150 | 200 | 250 | 300 | 1000 BIS 6000 ¹⁾ | 400 | 300 |
| 400 | 100 | 150 | 200 | 250 | 300 | 1000 BIS 6000 ¹⁾ | 400 | 300 |
| 450 | 100 | 150 | 200 | 250 | 300 | 1000 BIS 6000 ¹⁾ | 400 | 300 |
| 500 | 100 | 150 | 200 | 250 | 300 | 1000 BIS 6000 ¹⁾ | 400 | 300 |
| 550 | 100 | 150 | 200 | 250 | 300 | 1000 BIS 6000 ¹⁾ | 400 | 300 |
| 600 | 100 | 150 | 200 | 250 | 300 | 1000 BIS 6000 ¹⁾ | 400 | 300 |
| 700 | 100 | 150 | 200 | 250 | 300 | 1000 BIS 6000 ¹⁾ | 400 | 300 |
| 800 | 100 | 150 | 200 | 250 | 300 | 1000 BIS 6000 ¹⁾ | 400 | 300 |
| 900 | 100 | 150 | 200 | 250 | 300 | 1000 BIS 6000 ¹⁾ | 400 | 300 |
| 1000 | 100 | 150 | 200 | 250 | 300 | 1000 BIS 6000 ¹⁾ | 400 | 300 |
| 1200 | 100 | 150 | 200 | 250 | 300 | 1000 BIS 6000 ¹⁾ | 400 | 300 |
| 1300 | 100 | 150 | 200 | 250 | 300 | 1000 BIS 6000 ¹⁾ | 400 | 300 |
| 1400 | 100 | 150 | 200 | 250 | 300 | 1000 BIS 6000 ¹⁾ | 400 | 300 |
| 1500 | 100 | 150 | 200 | 250 | 300 | 1000 BIS 6000 ¹⁾ | 400 | 300 |
| 1600 | 100 | 150 | 200 | 250 | 300 | 1000 BIS 6000 ¹⁾ | 400 | 300 |
| 1800 | 100 | 150 | 200 | 250 | 300 | 1000 BIS 6000 ¹⁾ | 400 | 300 |
| 2000 | 100 | 150 | 200 | 250 | 300 | 1000 BIS 6000 ¹⁾ | 400 | 300 |

¹⁾ Abzweig oder T- Stück in der Standardlänge von 6,0m oder im Paßstück möglich

Profile- Spiral Pipe Branch

Pipe according to DIN 16961

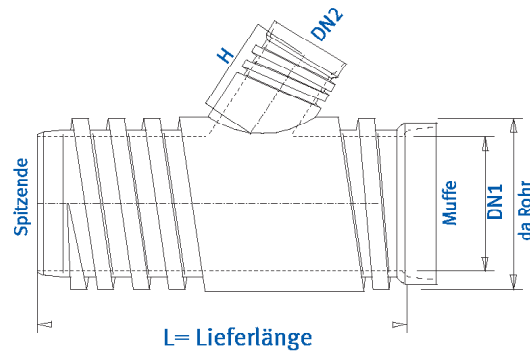

Delivery Length:
Specific Length:
Inside Surface:
Socket:
Socket:
Socket:
Material:

6,0m
according to inquiry
coextruded, colored Inliner
Form I, Extrusion welding
Form I, E- Socket welding
Form III, flat ends
PE- HD

| Nominal Width Main Pipe | Nominal width Branch |
|----------------------------|----------------------------------|
| DN 1 (mm) | DN 2²⁾ (mm) |
| 400 | 350 BIS 400 |
| 450 | 350 BIS 450 |
| 500 | 350 BIS 500 |
| 600 | 350 BIS 600 |
| 700 | 350 BIS 700 |
| 800 | 350 BIS 800 |
| 900 | 350 BIS 900 |
| 1000 | 350 BIS 1000 |
| 1200 | 350 BIS 1200 |
| 1300 | 350 BIS 1300 |
| 1400 | 350 BIS 1400 |
| 1500 | 350 BIS 1500 |
| 1600 | 350 BIS 1600 |
| 1800 | 350 BIS 1700 |
| 2000 | 350 BIS 1800 |
| 2200 | 100 BIS 2200 |
| 2300 ¹⁾ | 100 BIS 2300 |
| 2400 | 100 BIS 2400 |
| 2600 | 100 BIS 2600 |
| 3000 | 100 BIS 3000 |
| 3600 | 100 BIS 3600 |

Special Sizes
Branch 45°- 89°;
T- Piece 90°
based on inquiry

¹⁾ In Vorbereitung
²⁾ Abstufung der Nennweite wie bei Hauptrohr

HENZE GmbH
Kunststoffwerk

Josef-Kitz-Str. 9
53840 Troisdorf

tel: +49 (0) 2241- 98 19 0
fax: +49 (0) 2241- 98 19 20

e-mail: info@henze-gmbh.de
internet: www.henze-gmbh.de

Pipe according to DIN 16961

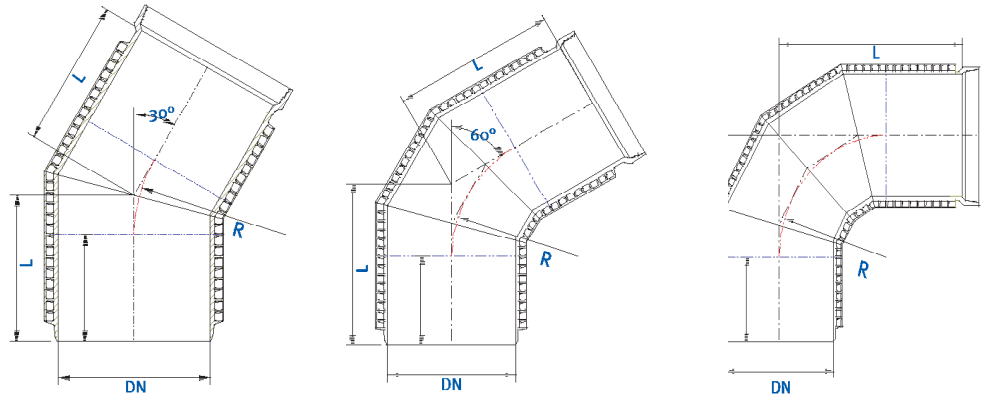

Delivery Length:
Specific Length:
Inside Surface:
Socket:
Socket:
Socket:
Material:

6,0m
according to inquiry
coextruded, colored Inliner
Form I, Extrusion welding
Form I, E-Socket welding
Form III, flat ends
PE- HD

| Nominal width | Radius R= Di | 15° | 30° | 45° | 60° | 90° |
|---------------|-----------------|-----------|-----------|-----------|-----------|-----------|
| DN (mm) | R (mm) | L (mm) | L (mm) | L (mm) | L (mm) | L (mm) |
| 350 | 350 | 250 | 300 | 350 | 400 | 550 |
| 400 | 400 | 255 | 310 | 370 | 430 | 600 |
| 450 | 450 | 260 | 320 | 390 | 460 | 650 |
| 500 | 500 | 270 | 355 | 410 | 490 | 700 |
| 600 | 600 | 280 | 360 | 450 | 550 | 800 |
| 700 | 700 | 290 | 390 | 490 | 600 | 900 |
| 800 | 800 | 310 | 420 | 530 | 660 | 1000 |
| 900 | 900 | 320 | 440 | 570 | 720 | 1100 |
| 1000 | 1000 | 330 | 470 | 610 | 780 | 1200 |
| 1200 | 1200 | 360 | 520 | 700 | 890 | 1400 |
| 1300 | 1300 | 370 | 550 | 740 | 950 | 1500 |
| 1400 | 1400 | 390 | 580 | 780 | 1000 | 1600 |
| 1500 | 1500 | 400 | 600 | 820 | 1070 | 1700 |
| 1600 | 1600 | 410 | 630 | 863 | 1120 | 1800 |
| 1800 | 1800 | 440 | 680 | 950 | 1240 | 2000 |
| 2000 | 2000 | 460 | 740 | 1030 | 1360 | 2200 |
| 2200 | 2200 | 490 | 790 | 1100 | 1470 | 2400 |

DN 2300- 3600: info after inquiry

Profile- Spiral Pipe Tangential Shaft

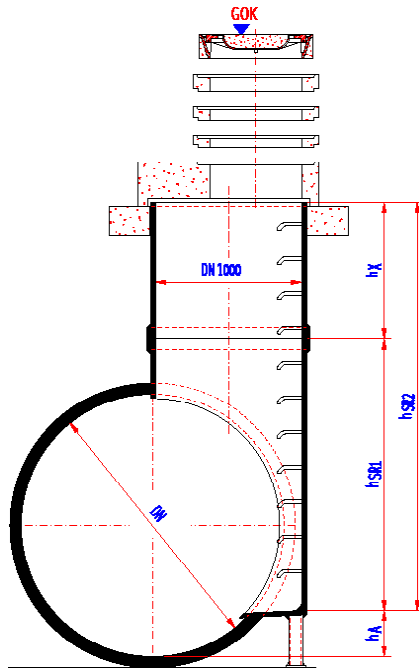

according to DIN 16961

With Step

Delivery Length:
Specific Length:
Inside Surface:
Socket:
Socket:
Socket:
Material:

6,0m
according to inquiry
coextruded, colored Inliner
Form I, Extrusion welding
Form I, E- Socket welding
Form III, flat ends
PE- HD

| Main Pipe | Hight of Auftritt | Hight of Shaft Pipe Standard Construction I | Hight of Shaft Pipe Standard Construction II |
|-----------|-------------------|---|--|
| DN (mm) | h_A (mm) | h_{SR1} (mm) | h_{SR2} (mm) |
| 800 | 400 | 950 | $h_{SR1} + h_x$ |
| 900 | 450 | 1000 | $h_{SR1} + h_x$ |
| 1000 | 500 | 1050 | $h_{SR1} + h_x$ |
| 1200 | 500 | 1250 | $h_{SR1} + h_x$ |
| 1300 | 500 | 1350 | $h_{SR1} + h_x$ |
| 1400 | 500 | 1450 | $h_{SR1} + h_x$ |
| 1500 | 500 | 1600 | $h_{SR1} + h_x$ |
| 1600 | 500 | 1700 | $h_{SR1} + h_x$ |
| 1800 | 500 | 1900 | $h_{SR1} + h_x$ |
| 2000 | 500 | 2100 | $h_{SR1} + h_x$ |
| 2200 | 500 | 2300 | $h_{SR1} + h_x$ |
| 2300 | 500 | 2400 | $h_{SR1} + h_x$ |
| 2400 | 500 | 2500 | $h_{SR1} + h_x$ |
| 2600 | 500 | 2700 | $h_{SR1} + h_x$ |
| 3000 | 500 | 3100 | $h_{SR1} + h_x$ |
| 3600 | 500 | 3700 | $h_{SR1} + h_x$ |

PE-HD- Shaft Pipe DN 1000 with light Pipe inner surface tangential to the canalisation pipe; Schaft Pipe Hight up to 500mm above the Pipe vertex of the canalisation pipe; Standing area 500mm above Pipe Floor, Steps; Shafts flat on top in order to place prefabricated parts out of concrete and Steel concrete according to DIN 4034 to OK Site.

HENZE GmbH
Kunststoffwerk

Josef-Kitz-Str. 9
53840 Troisdorf

tel: +49 (0) 2241- 98 19 0
fax: +49 (0) 2241- 98 19 20

e-mail: info@henze-gmbh.de
internet: www.henze-gmbh.de

Profile- Spiral Pipe Tangential Shaft

Pipe according to DIN 16961

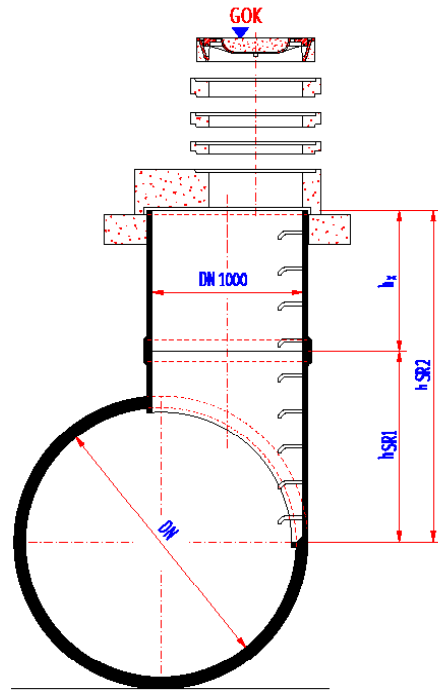

Delivery Length:
Specific Length:
Inside Surface:
Socket:
Socket:
Socket:
Material:

coextruded, colored material
Form I, Extrusion welding
Form I, E-socket welding
Form III, flat ends
PE- HD

PE-HD Shaft Pipe DN 1000 with light Pipe Inside Lining, steps tangentially to the shaft pipe.
Shaft pipe above canal pipe axis up to 500mm.
Shaft pipe is flat on top in order to put on concrete and concrete steel parts according to DN 4034 .

| Main Pipe | Hight of Shaft pipe Standard Construction | hight of Shaft Pipe Stand- ard Construction II |
|------------|--|---|
| DN (mm) | h_{SR1} (mm) | h_{SR2} (mm) |
| 1500 | 1350 | $h_{SR1} + h_x$ |
| 1600 | 1400 | $h_{SR1} + h_x$ |
| 1800 | 1500 | $h_{SR1} + h_x$ |
| 2000 | 1600 | $h_{SR1} + h_x$ |
| 2200 | 1700 | $h_{SR1} + h_x$ |
| 2300 | 1750 | $h_{SR1} + h_x$ |
| 2400 | 1800 | $h_{SR1} + h_x$ |
| 2600 | 1900 | $h_{SR1} + h_x$ |
| 3000 | 2100 | $h_{SR1} + h_x$ |
| 3600 | 2400 | $h_{SR1} + h_x$ |

Profile- Spiral Pipe Passing Shaft

Pipe according to DIN 16961

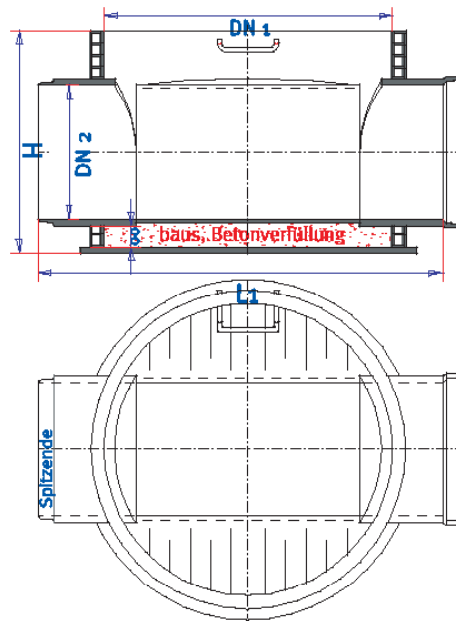

Delivery Length:
Specific Length:
Inside Surface:
Socket:
Socket:
Socket:
Material:

6,0m
according to inquiry
coextruded, colored Inliner
Form I, Extrusion welding
Form I, E- Socket welding
Form III, flat ends
PE- HD

| Shaft | Intake/ drain | Shaft height |
|-------------------------------|-----------------------------------|--------------------------|
| DN₁ (mm) | max DN₂ (mm) | Hight H (mm) |
| 1000 | 300 | 750 -according to demand |
| 1000 | 400 | 750-according to demand |
| 1000 | 500 | 1000-according to demand |
| 1200 | 600 | 1000-according to demand |
| 1200 | 700 | 1250-according to demand |
| 1500 | 800 | 1250-according to demand |
| 1500 | 900 | 1250-according to demand |

HENZE GmbH
Kunststoffwerk

Josef-Kitz-Str. 9
53840 Troisdorf

tel: +49 (0) 2241- 98 19 0
fax: +49 (0) 2241- 98 19 20

e-mail: info@henze-gmbh.de
internet: www.henze-gmbh.de

Tight- and Pressure Tight Wallconnection

Wall connection for inserting PE-HD-Pipes into buildings and Shafts from Concrete and masonry. A minimum coverage of the sealing elements should not be less 3 cm.

Wall connection Type 1

Wall connection Profile
Spiral Pipe according to
DIN 16961

| Nominal width | Type1 | | Type2 |
|---------------|---------|---------|---------|
| | T1 (mm) | T2 (mm) | T1 (mm) |
| 350-700 | 20 | 5 | 20 |
| 800-1000 | 20 | 10 | 20 |
| 1200-1500 | 25 | 10 | 25 |
| 1600-2000 | 30 | 10 | * |
| 2200-3600 | 40 | 15 | * |

* Anwendung auf Anfrage

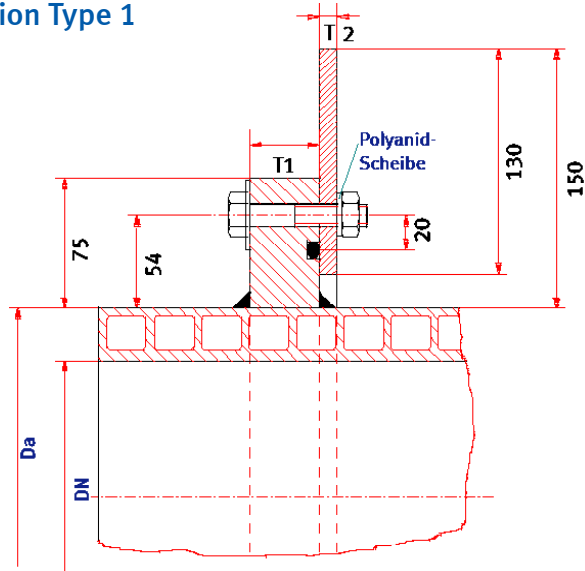

Pressure water tight - and sealed wall connection, consisting of a pipe with welded on PE-HD wall flange, steel flange screwed together with a wall flange and sealed with round about string gasket seal.

Wall Connection Type 2

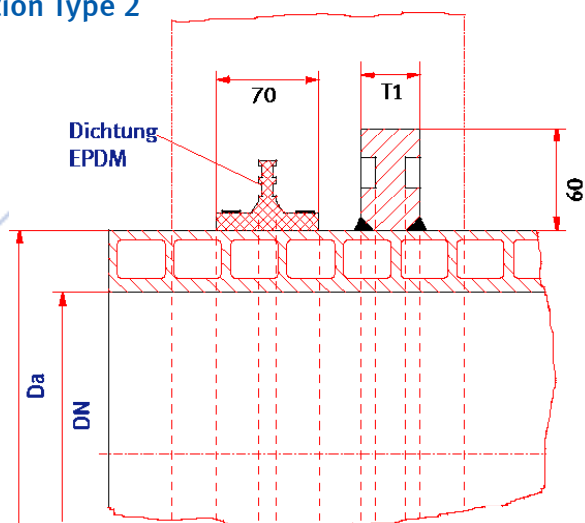

Pressure water tight - and sealed wall connection, consisting of a pipe with welded on PE-HD wall flange, wall collar out of EPDM and gripping jaw out of stainless steel.

Tight- and Pressure Tight Wall Capsule

The Wall capsule is special for inserting fittings into the concrete, in order that connection of canalisation pipes is possible later on. The wall capsule is poured into the shaft wall. The connecting canalisation pipe is run through the wall capsule and is welded together. A minimum coverage of the sealing element should not be less than 3cm.

Wall Capsule

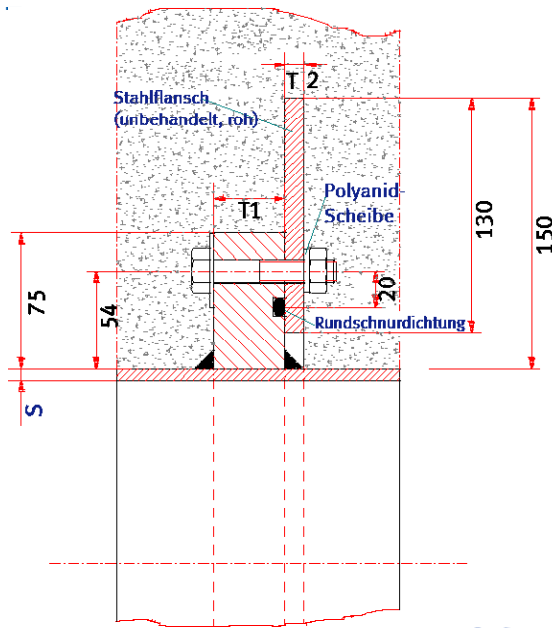

Wall Capsule (Shaft food)
Profile Spiral Pipe according to DIN 16961

| Nominal width | Type1 | | | Type2 | |
|---------------|--------|---------|---------|--------|---------|
| | S (mm) | T1 (mm) | T2 (mm) | S (mm) | T1 (mm) |
| 350-700 | 15 | 20 | 5 | 15 | 20 |
| 800-1000 | 15 | 20 | 10 | 15 | 20 |
| 1200-1500 | 15 | 25 | 10 | 15 | 25 |
| 1600-2000 | 20 | 30 | 10 | * | * |
| 2200-3600 | 30 | 40 | 15 | * | * |

* Application after inquiry

Pressure water tight- sealed wall capsule, consisting of a wall pipe welded together with PE-HD wall flange, steel flange screwed together with a wall flange and sealed with round about string gasket seal.

Wall Capsule Type

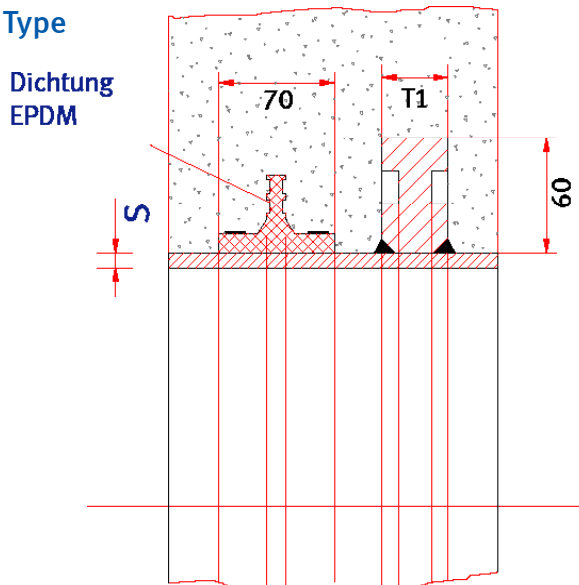

Pressure water tight - and sealed wall connection, consisting of a pipe with welded on PE-HD wall flange, wall collar out of EPDM and gripping jaw out of stainless steel.

HENZE GmbH
Kunststoffwerk

Josef-Kitz-Str. 9
53840 Troisdorf

tel: +49 (0) 2241- 98 19 0
fax: +49 (0) 2241- 98 19 20

e-mail: info@henze-gmbh.de
internet: www.henze-gmbh.de

House Connection Saddle

Using the House Connection Saddle incoming house pipes can be connected to the profile pipe. A DA 160 pipe is connected on the side with the main line in a 90° angle. The welding connection is done with hot plate butt welding. The house connection saddle can be supplied for a diameter from DN 300 to DN 3600.

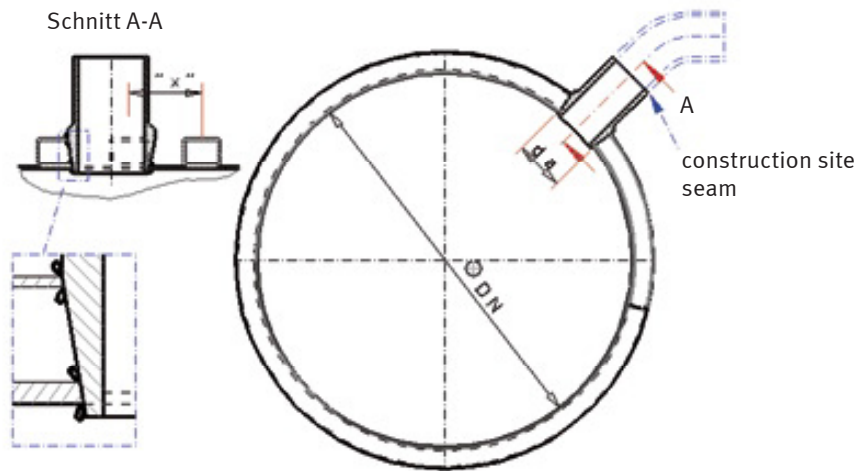

The welding of the house connection saddle is done with E-Socket.

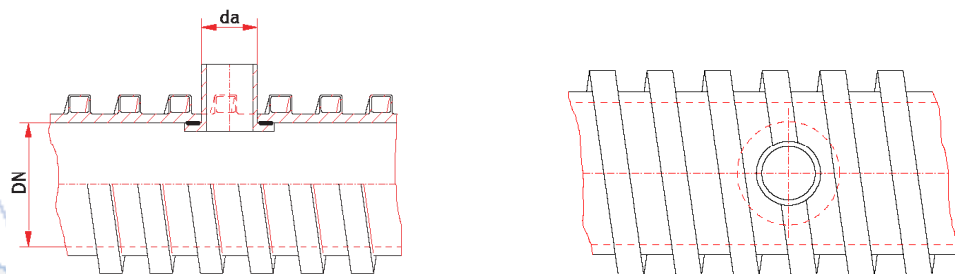

If the connection of the side intake is done through extrusion welding, then the connection can be done in any angle desired.

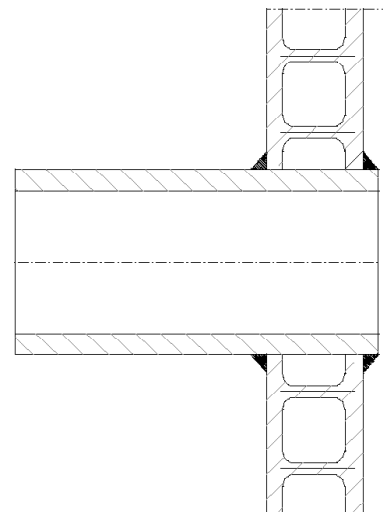

Concrete Steel Cover Plate

for HENZE Shaft buildings

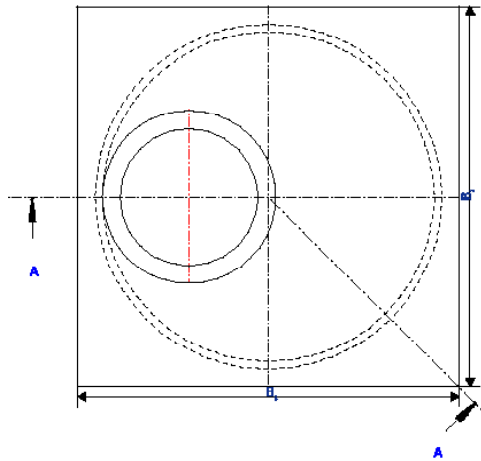
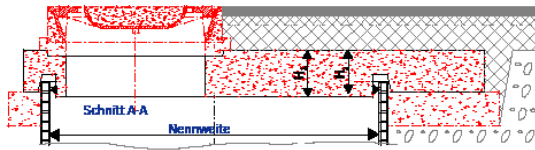

With the Tasiko-KC steel concrete cover plate verticals and horizontal are diverted to the carrying layer. The dynamic weights are transferred from the shaft cover to the shaft. Cover plate suitable in traffic areas up to SIW 60. The interior and therefore protected sealing according to DIN 4060 guarantees an optimal sealed area for a lasting sealed area.

| Nominal width | B ₁ | B ₂ | H ₁ | H ₂ |
|---------------|----------------|----------------|----------------|----------------|
| 800 | 1100 | 1100 | 210 | 190 |
| 1000 | 1250 | 1250 | 210 | 190 |
| 1200 | 1440 | 1440 | 210 | 190 |
| 1300 | 1580 | 1580 | 210 | 190 |
| 1400 | 1740 | 1740 | 210 | 190 |
| 1500 | 1800 | 1800 | 230 | 210 |
| 1600 | 2000 | 2000 | 230 | 210 |
| 1800 | 2300 | 2300 | 230 | 210 |
| 2000 | 2300 | 2300 | 270 | 250 |
| 2240 | 2600 | 2600 | 270 | 250 |
| 2400 | 2800 | 2800 | 340 | 320 |
| 2600 | 3000 | 3000 | 340 | 320 |
| 3000 | 3400 | 3400 | 340 | 320 |

HENZE GmbH
Kunststoffwerk

Josef-Kitz-Str. 9
53840 Troisdorf

tel: +49 (0) 2241- 98 19 0
fax: +49 (0) 2241- 98 19 20

e-mail: info@henze-gmbh.de
internet: www.henze-gmbh.de

Information request

Please send us more Information on the following products:

- General Information
- Pipe Systems
- Information on Electrofusion Welding
- Landfill Technology
- Chemical - and Systems Engineering
- Tenders
- Please arrange a meeting with us for an elaborate consultation

Company _____

Correspondance person _____

City / Zip Code _____

Country _____

E-Mail _____

Telefon _____

Fax _____